



KUBO.25



KUBO.16



KUBO.9



KUBO.4



KUBO.1



KUBO.0



KUBO.MIN



KUBO.NANO

RECTANGULAR PROJECTORS
KUBO SERIES

KUBO.25

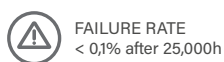

RECTANGULAR PROJECTORS
KUBO SERIES

References

Code	Type	Finish	Light Color	Power	Lense		Voltage	Driver	
VL-KUB25	A Base	LG Light grey	White						
	B Base 2	DK Dark grey	W24 2400K	90W	1,5° (90W)	2,5°	UNIV 100-264Vac	STD ON/OFF	
	C Pole Arm	WH White	W27 2700K	120W	4,5°	8°		010 0-10V	
		BK Black	W30 3000K		12°	20°	DALI		
		RAL Any RAL color	W40 4000K		30°	40°	CAS Casambi		
			W60 6000K		60°	5x20°			
					10x70°	ASYM			
				Single Color (SC)					
				R Red	120W	4,5°	8°	UNIV 100-264Vac	STD ON/OFF
				B Blue		12°	20°	010 0-10V	
				G Green		30°	40°	DALI	
				A Amber		60°	5x20°	CAS Casambi	
						10x70°			
				RGBW					
				RGBW3	150W	8°	15°	UNIV 100-264Vac	DALI
			4 in 1 Chip		20°	30°		DMX	
			RGB+W3000K		60°	15x60°	36 36Vdc	CAS Casambi	
			RGBW4						
			4 in 1 Chip						
			RGB+W4000K						
			RGBW7						
			7 in 1 Chip						
			RGBWCLA						

Reference example

VL-KUB25-C-DK-W60-120W-60°-UNIV-STD

Variations



A
Base



B
Base 2



C
Pole Arm
D=45mm

Dimensions

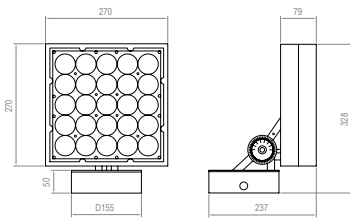

TYPE A

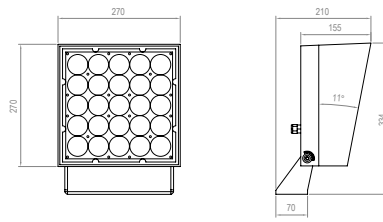

TYPE B

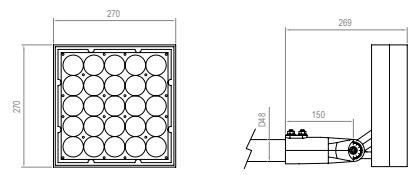

TYPE C

Accessories

Code	Accessories
------	-------------

VL-KUB25 HC Honeycomb Grid
MSH Mesh

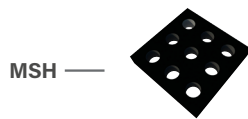
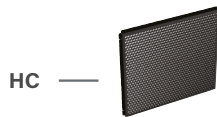

Code	Accessories
------	-------------

VL-KUB25 SHD Shields
 *1BR Bracket for 1 projector
 *2BR Bracket for 2 projector
 *CBLX Special length cable
** Must be used with Type C*
** Must be used with Type C*
** Instead of X, put length of cable needed*
 Example: VL-KUB25-CBL-10m

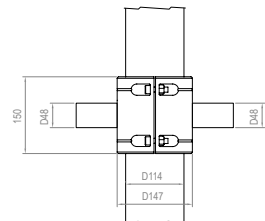
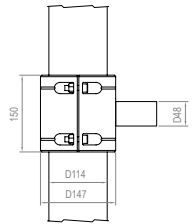
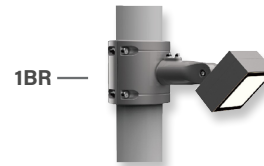

KUBO.16

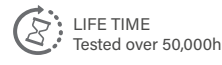
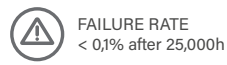

RECTANGULAR PROJECTORS
KUBO SERIES

References

Code	Type	Finish	Light Color	Power	Lense		Voltage	Driver	
VL-KUB16	A Base	LG Light grey	White						
	B Base 2	DK Dark grey	W24 2400K	50W	1,5° (50W)	2,5°	UNIV 100-264Vac	STD ON/OFF	
	C Pole Arm	WH White	W27 2700K	75W	4,5°	8°		010 0-10V	
	D Pole mounted	BK Black	W30 3000K		12°	20°	DALI	CAS Casambi	
	E Stripe mounted	RAL Any RAL color	W40 4000K		30°	40°			
			W60 6000K		60°	5x20°	ASYM		
				Single Color (SC)					
			R Red		75W	2,5°	6°	UNIV 100-264Vac	STD ON/OFF
			B Blue			12°	20°		010 0-10V
			G Green			30°	40°	DALI	CAS Casambi
			A Amber			60°	5x20°		
				RGBW					
			RGBW3		100W	15°	20°	UNIV 100-264Vac	DALI
			4 in 1 Chip RGB+W3000K			30°	60°		36 36Vdc
			RGBW4			15x60°		CAS Casambi	
		4 in 1 Chip RGB+W4000K							
		RGBW7							
		7 in 1 Chip RGBWCLA							

Reference example

VL-KUB16-C-DK-W60-75W-20°-UNIV-STD

Variations



A
Base



B
Base 2



C
Pole Arm
D=45mm



D
Pole mounted
D67-325mm

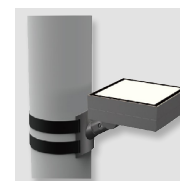

E
Stripe mounted

Dimensions

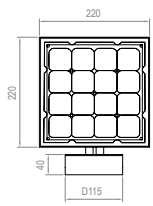

TYPE A

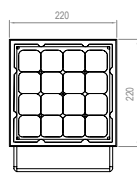

TYPE B

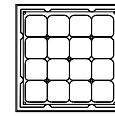
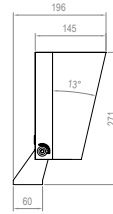

TYPE C

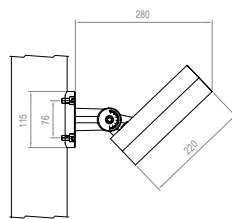
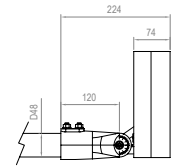

TYPE D

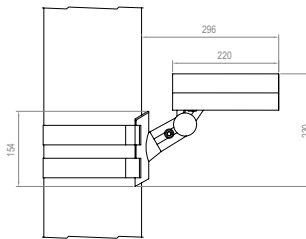

TYPE E

Accessories

Code	Accessories
VL-KUB16	HC Honeycomb Grid MSH Mesh

HC



MSH

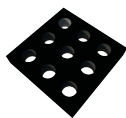

Code	Accessories
VL-KUB16	SHD Shields *1BR Bracket for 1 projector *2BR Bracket for 2 projector *CBLX Special length cable

* Must be used with Type C
* Must be used with Type C
* Instead of X, put length of cable needed
Example: VL-KUB25-CBL-10m

SHD



1BR

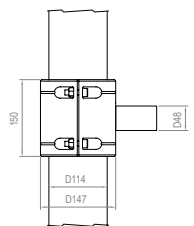

2BR

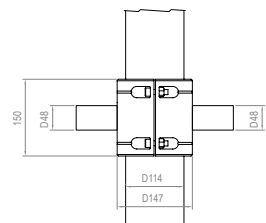
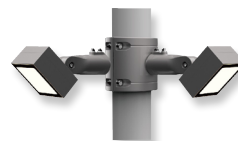

KUBO.9

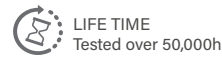
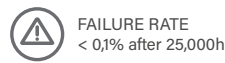

RECTANGULAR PROJECTORS
KUBO SERIES

References

Code	Type	Finish	Light Color	Power	Lense		Voltage	Driver	
VL-KUB9	A Base	LG Light grey	White						
	B Base 2	DK Dark grey	W24 2400K	45W	2°	4,5°	UNIV 100-264Vac	STD ON/OFF	
	C Pole Arm	WH White	W27 2700K		8°	12°			
	D Pole mounted	BK Black	W30 3000K		20°	30°			
	E Stripe mounted	RAL Any RAL color	W40 4000K		40°	60°	24 24Vdc	010 0-10V	
	F Nut		W60 6000K		5x20°	10x70°		DALI	
					ASYM			CAS Casambi	
				Single Color (SC)					
				R Red	45W	4,5°	8°	UNIV 100-264Vac	STD ON/OFF
			B Blue	12°		20°			
			G Green	30°		40°			
			A Amber	60°		5x20°			
				10x70°			24 24Vdc	010 0-10V	
							DALI		
							CAS Casambi		
			RGBW						
			RGBW3	60W	15°	20°	UNIV 100-264Vac	DALI	
			4 in 1 Chip		30°	60°			
			RGB+W3000K		15x60°	36 36Vdc			
			RGBW4				DMX		
			4 in 1 Chip				CAS Casambi		
			RGB+W4000K						

Reference example

VL-KUB9-A-DK-W30-45W-2,5°-UNIV-DALI

Variations



A
Base



B
Base 2



C
Pole Arm
D=45mm



D
Pole mounted
D67-325mm

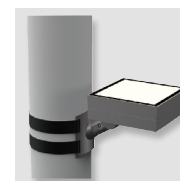

E
Stripe mounted



F
Nut (M10x1,5mm)

Dimensions

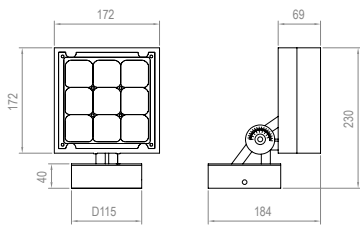

TYPE A

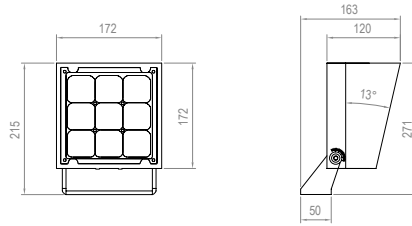

TYPE B

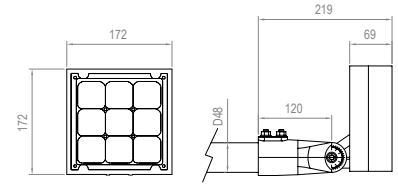

TYPE C

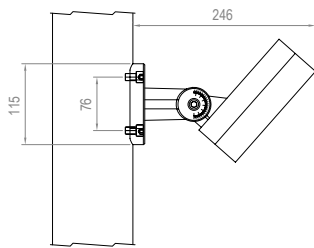

TYPE D

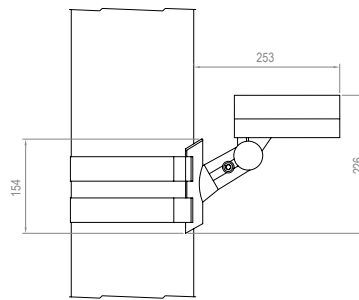

TYPE E

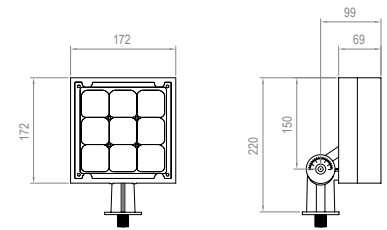

TYPE F

Accessories

Code	Accessories
VL-KUB9	HC Honeycomb Grid MSH Mesh

HC



MSH



Code	Accessories
VL-KUB9	SHD Shields *SPK SPIKE *1BR Braket for 1 projector *2BR Braket for 2 projector *BX Elevated Box *CBLX Special length cable

** Must be used with Type F
* Must be used with Type C
* Must be used with Type C
* Must be used with Type F
* Instead of X, put length of cable needed
Example: VL-KUB9-CBL-10m*

SHD



SPK



BX

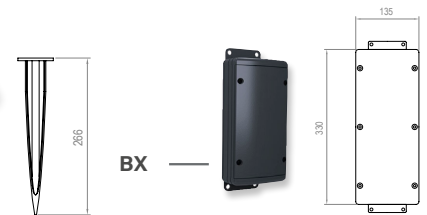

1BR

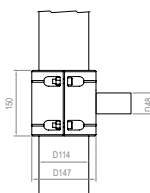
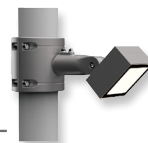

2BR

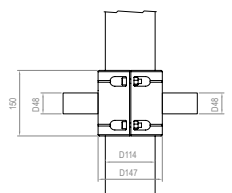
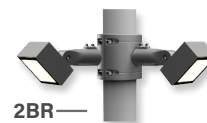

KUBO.4

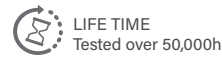
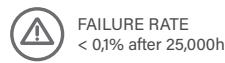

RECTANGULAR PROJECTORS
KUBO SERIES

References

Code	Type	Finish	Light Color	Power	Lense		Voltage	Driver	
VL-KUB4	A Base	LG Light grey	White						
	B Base 2	DK Dark grey	W24 2400K	20W	2°	4,5°	UNIV 100-264Vac	STD ON/OFF	
	C Pole Arm	WH White	W27 2700K		8°	12°			
	D Pole mounted	BK Black	W30 3000K	20W	20°	30°	24 24Vdc	010 0-10V	
	E Stripe mounted	RAL Any RAL color	W40 4000K		40°	60°			
	F Nut		W60 6000K		5x20°	10x70°			DALI
						ASYM		CAS Casambi	
				Single Color (SC)					
				R Red	20W	4,5°	8°	UNIV 100-264Vac	STD ON/OFF
				B Blue		12°	20°		
				G Green	20W	30°	40°	24 24Vdc	010 0-10V
				A Amber		60°	5x20°		
						10x70°		DALI	CAS Casambi
				RGBW					
				RGBW3	20W	8°	20°	24 24Vdc	DALI
			4 in 1 Chip	30W	15°	60°			
			RGB+W3000K		30°			DMX	
			RGBW4		15x60°			CAS Casambi	
			4 in 1 Chip						
			RGB+W4000K						

Reference example

VL-KUB4-A-WH-W24-20W-60°-STD

Variations



A
Base



B
Base 2



C
Pole Arm
D=45mm



D
Pole mounted
D67-325mm

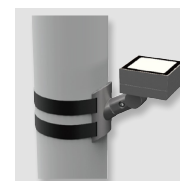

E
Stripe mounted



F
Nut (M10x1,5mm)

Dimensions

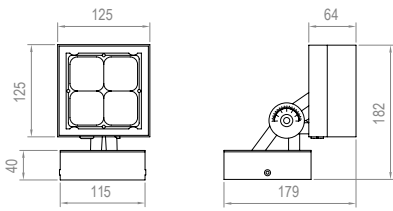

TYPE A

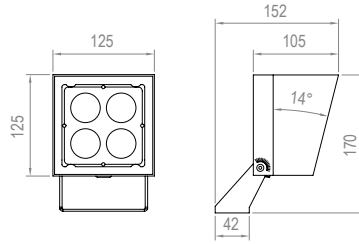

TYPE B

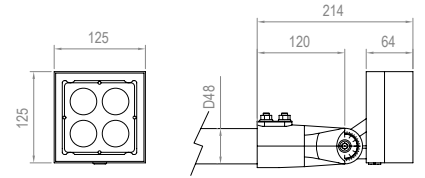

TYPE C

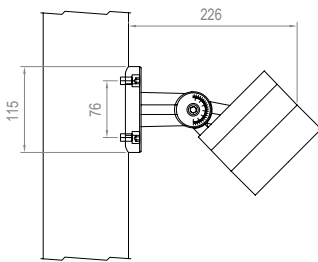

TYPE D

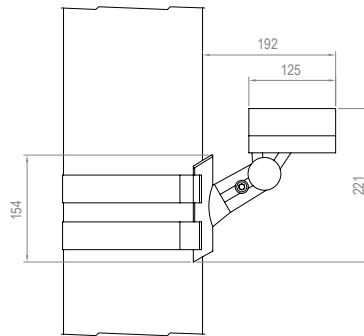

TYPE E

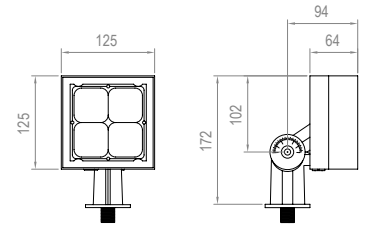

TYPE F

Accessories

Code	Accessories
------	-------------

VL-KUB4 HC Honeycomb Grid
MSH Mesh

HC



MSH

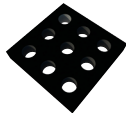

Code	Accessories
------	-------------

VL-KUB4 SHD Shields
*SPK SPIKE
*1BR Braket for 1 projector
*2BR Braket for 2 projector
*BX Elevated Box
*CBLX Special length cable

** Must be used with Type F*
** Must be used with Type C*
** Must be used with Type C*
** Must be used with Type F*
** Instead of X, put length of cable needed*
Example: VL-KUB9-CBL-10m

SHD



SPK



BX

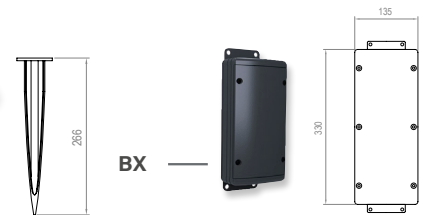

1BR

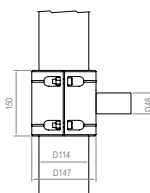
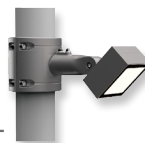

2BR

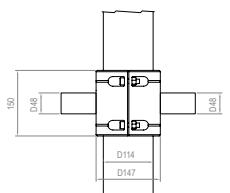
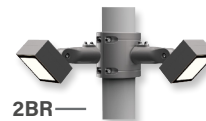

KUBO.1

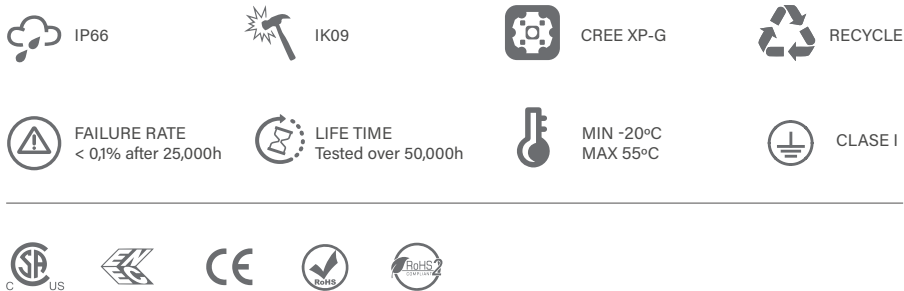

RECTANGULAR PROJECTORS
KUBO SERIES

References

Code	Finish	Light Color	Power	Lense		Voltage	Driver
VL-KUB1	LG Light grey DK Dark grey WH White BK Black RAL Any RAL color	White					
		W24 2400K	10W	2°	4,5°	UNIV 100-264Vac	STD ON/OFF
		W27 2700K		8°	12°		24 24Vdc
		W30 3000K		20°	30°	RD Remote DALI	
		W40 4000K		40°	60°	CAS Casambi	
		W60 6000K		5x20°	10x70°		
		Single Color (SC)					
		R Red	10W	4,5°	8°	UNIV 100-264Vac	STD ON/OFF
		B Blue		12°	20°		24 24Vdc
		G Green		30°	40°	RD Remote DALI	
		A Amber		60°	5x20°	CAS Casambi	
				10x70°			
		RGBW					
		RGBW3	10W	8°	15°	24 24Vdc	RD Remote DALI
		4 in 1 Chip		20°	30°		DMX
RGB+W3000K	60°	15x60°		CAS Casambi			
RGBW4		4 in 1 Chip					
RGB+W4000K		RGB+W4000K					

Reference example

VL-KUB1-WH-W24-10W-40°-UNIV-STD

Dimensions

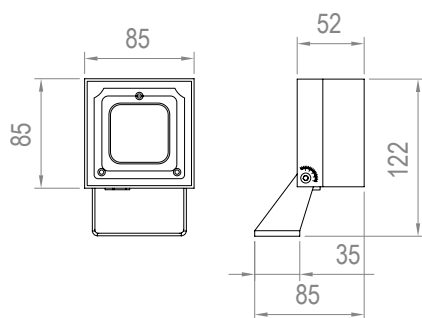

Accessories

Code	Accessories
VL-KUB1	HC Honeycomb Grid

HC

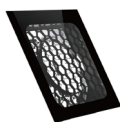

Code	Accessories
VL-KUB1	*SPK SPIKE *CLP Clap *VSR Visor *CBLX Special length cable

** Instead of X, put length of cable needed
Example: VL-KUB1-CBL-10m*

SPK

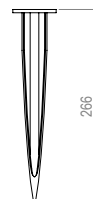

CLP

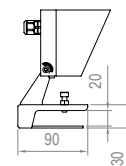
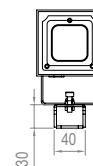

VSR

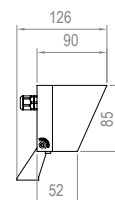

KUBO.0

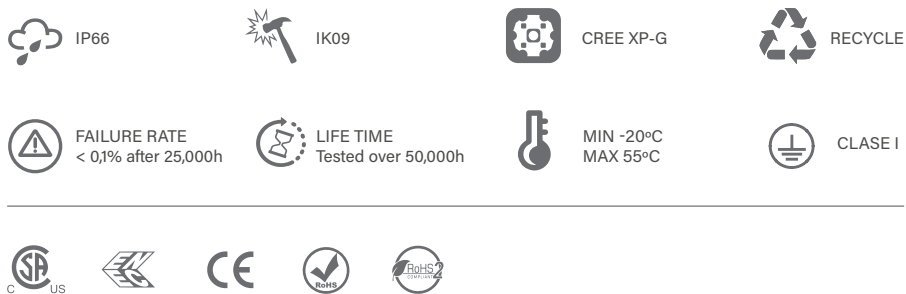

RECTANGULAR PROJECTORS
KUBO SERIES

References

Code	Finish	Light Color	Power	Lense		Voltage	Driver
VL-KUB.0	LG Light grey DK Dark grey WH White BK Black RAL Any RAL color	White					
		W24 2400K	10W	2°	6°	24 24Vdc	STD ON/OFF
		W27 2700K		8°	12°		
		W30 3000K		20°	30°		
		W40 4000K		40°	60°		
		W60 6000K		5x20°	10x70°		
		Single Color (SC)					
		R Red	10W	6°	8°	24 24Vdc	STD ON/OFF
		B Blue		12°	20°		
		G Green		30°	40°		
		A Amber		60°	5x20°		
				10x70°			
		RGBW					
		RGBW3	10W	15°	20°	24 24Vdc	RD Remote DALI
		4 in 1 Chip RGB+W3000K		30°	60°		
RGBW4	10W	15x60°		24 24Vdc	DMX		
4 in 1 Chip RGB+W4000K							
						<input type="checkbox"/> RCAS Remote Casambi	

Reference example

VL-KUB0-WH-W24-10W-12°-24-STD

Dimensions

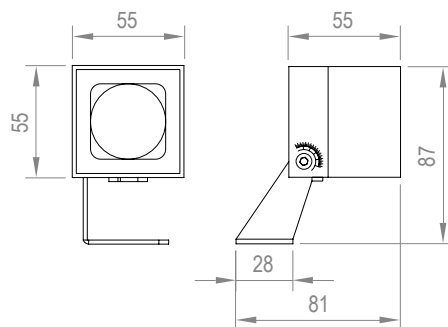

Accessories

Code	Accessories
VL-KUB0	HC Honeycomb Grid

HC

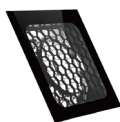

Code	Accessories
VL-KUB0	<ul style="list-style-type: none"> *SPK SPIKE *CLP Clap *VSR Visor *CBLX Special length cable

** Instead of X, put length of cable needed
Example: VL-KUB0-CBL-10m*

SPK

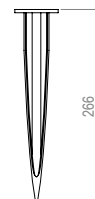

CLP

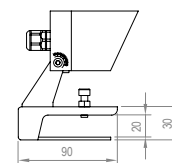
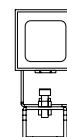

VSR

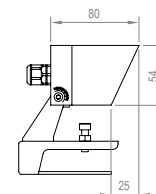

KUBO.MIN

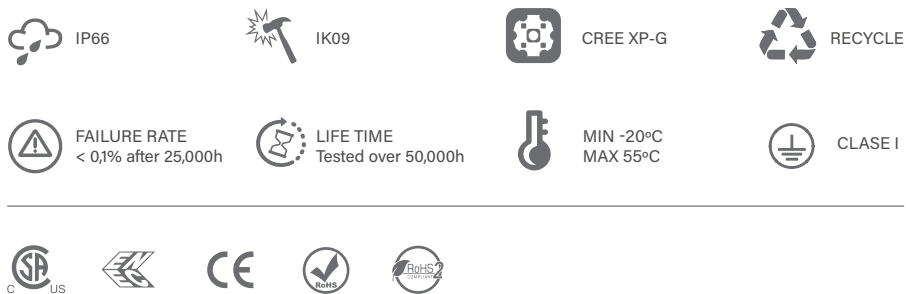

RECTANGULAR PROJECTORS
KUBO SERIES

References

Code	Finish	Light Color	Power	Lense		Voltage	Driver
VL-KUB.MIN	LG Light grey DK Dark grey WH White BK Black RAL Any RAL color	White					
		W24 2400K	6W	8°	12°	UNIV	STD ON/OFF
		W27 2700K		20°	30°		
		W30 3000K		40°	60°		
		W40 4000K		15x30°	10x70°		
		W60 6000K					
		Single Color (SC)					
		R Red	6W	4,5°	8°	UNIV	STD ON/OFF
		B Blue		12°	20°		
		G Green		30°	40°		
		A Amber		60°	5x20°		
				10x70°			
		RGBW					
		RGBW3	6W	20°	40°	12 12Vdc	RD Remote DALI
		4 in 1 Chip		60°	15x30°		
RGB+W3000K	15x60°						
RGBW4	6W	20°	40°	12 12Vdc	RD Remote DALI		
4 in 1 Chip		60°	15x30°				
RGB+W4000K		15x60°					

Reference example

VL-KUB.MIN-WH-W24-10W-12°-UNIV-STD

Dimensions

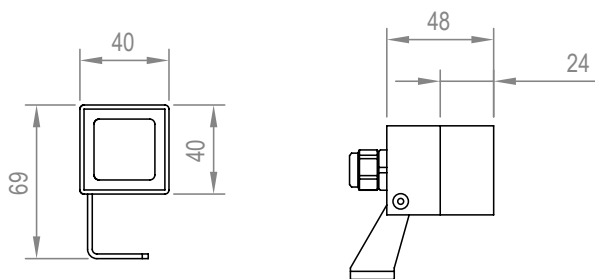

Accessories

Code	Accessories
VL-KUB.MIN	HC Honeycomb Grid

HC

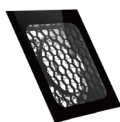

Code	Accessories
VL-KUB.MIN	*POLE Pole *CLP Clap *VSR Visor

POLE



*Instead of X, put length of cable needed
Example: VL-KUB.MIN-CBL-10m

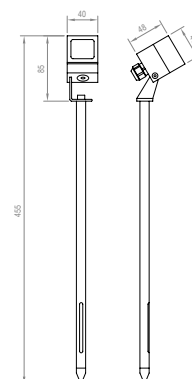

CLP

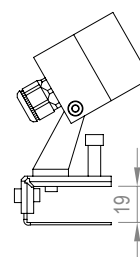

VSR

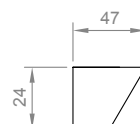

KUBO.NANO

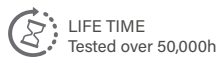
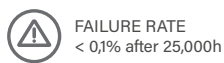
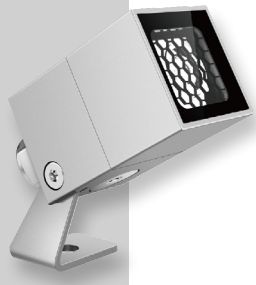

RECTANGULAR PROJECTORS
KUBO SERIES

References

Code	Finish	Light Color	Power	Lense		Voltage	Driver
VL-KUB.NANO	LG Light grey DK Dark grey WH White BK Black RAL Any RAL color	White					
		W24 2400K	3W	20°	30°	12 12Vdc	STD ON/OFF
		W27 2700K					
		W30 3000K	25x45°	24 24Vdc	R Remote 230V		
		W40 4000K					
	W60 6000K						
	Single Color (SC)						
	R Red	3W	20°	30°	12 12Vdc	STD ON/OFF	
	B Blue						
	G Green		25x45°	24 24Vdc	R Remote 230V		
A Amber							
R010 Remote 0-10V							
RD Remote DALI							
RCAS Remote Casambi							

Reference example

VL-KUB.NANO-WH-W24-10W-12°-UNIV-STD

Dimensions

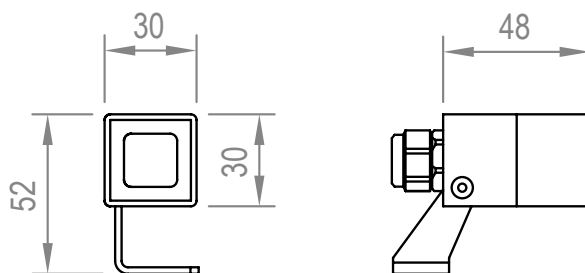

Accessories

Code	Accessories
VL-KUB.NANO	HC Honeycomb Grid

HC

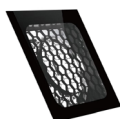

Code	Accessories
VL-KUB.NANO	<ul style="list-style-type: none"> *POLE Pole *CLP Clap *VSR Visor *CBLX Special length cable

** Instead of X, put length of cable needed
Example: VL-KUB.NANO-CBL-10m*

POLE

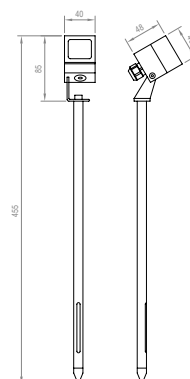

CLP

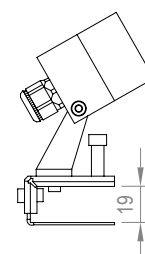

VSR

