

UGE



IP67	IK10	CREE XP-G	RECYCLE
FAILURE RATE < 0,1% after 25,000h	LIFE TIME Tested over 50,000h	MIN -20°C MAX 55°C	CLASE I

**UNDERGROUND
UNDERGROUND SERIES**

References

Code	Light Color	Size-Power	Lense		Voltage	Driver
VL-UGE	White					
	W24 2400K	Size A-10W	2°	4,5°	UNIV 100-264Vac	STD ON/OFF
	W27 2700K	Size B-10W	8°	12°		010 0-10V
	W30 3000K	Size C-20W	20°	30°		DALI
	W40 4000K	Size D-15W	40°	60°		CAS Casambi
	W60 6000K	Size D-30W	5x20°	10x70°		
		Size E-25W				
		Size E-50W				
		Size F-45W				
		Size F-90W				
	Single Color (SC)					
	R Red	Size A-10W	4,5°	8°	UNIV 100-264Vac	STD ON/OFF
	B Blue	Size B-10W	12°	20°		010 0-10V
	G Green	Size C-20W	30°	40°		DALI
	A Amber	Size D-15W	60°	5x20°		CAS Casambi
		Size D-30W	10x70°			
		Size E-25W				
		Size E-50W				
		Size F-45W				
		Size F-90W				
	RGBW					
	RGBW3	Size A-10W	15°	20°	UNIV 100-264Vac	DMX
	4 in 1 Chip	Size B-10W	30°	60°	(only size C,D,E,F)	
	RGB+W3000K	Size C-20W	15x60°		12 12Vdc	
		Size D-30W			(only size A)	
	RGBW4	Size E-50W			24 24Vdc	
	4 in 1 Chip	Size F-90W			(only size B)	
	RGB+W4000K					

Reference example

VL-UGE-W27-Size B-10W-2 -UNIV-STD

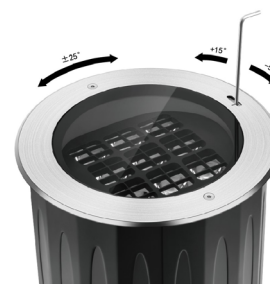

Orientation system from outside

Variations

SIZE A D=100mm	SIZE B D=135mm	SIZE C D=185mm	SIZE D D=215mm	SIZE E D=280mm	SIZE F D=300mm

Dimensions

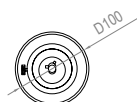
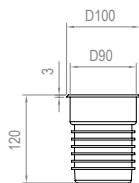

SIZE A

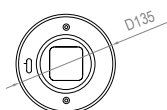
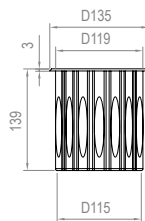

SIZE B

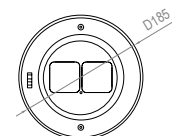
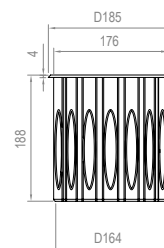

SIZE C

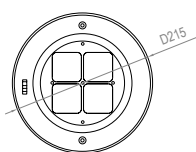
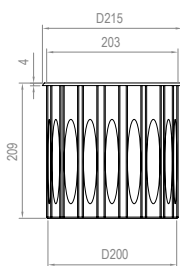

SIZE D

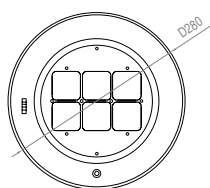
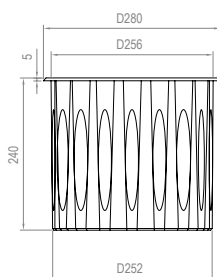

SIZE E

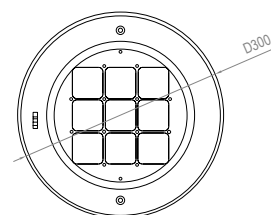
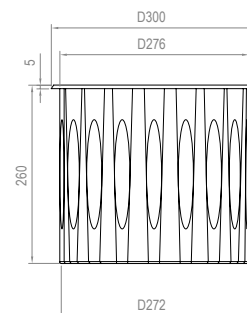

SIZE F

Accessories

Stainless steel recessed box is always included with the projector

Code	Accessories
VL-UGE	*CBLX Special length cable

** Instead of X, put length of cable needed
Example: VL-UGE-CBL-10m*