

# LINNEA.50

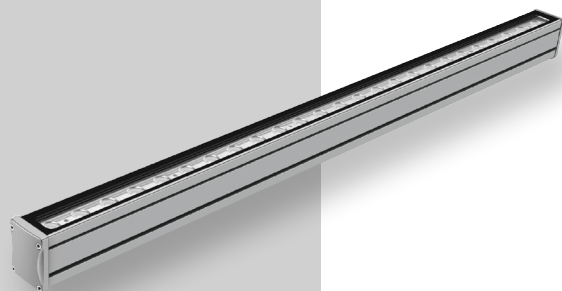

IP66



IK09



CREE XP-G



RECYCLE



FAILURE RATE  
< 0,1% after 25,000h



LIFE TIME  
Tested over 50,000h



MIN -20°C  
MAX 55°C



CLASE I



LINNERS  
**LINNEA SERIES**

## References

Code	Finish	Light Color	Lenght-Power	Lense		Voltage	Driver
VL-LN.50	LG Light grey RAL Any RAL color	<b>White</b>					
		<b>W24</b> 2400K	<b>500mm-11W</b>	<b>8°</b>	<b>12,5°</b>	<b>UNIV</b> 100-264Vac	<b>STD</b> ON/OFF
	<b>W27</b> 2700K	<b>1000mm-14W</b>	<b>20°</b>	<b>30°</b>	<b>24</b> 24Vdc	<b>010</b> 0-10V	
	<b>W30</b> 3000K	<b>1000mm-22W</b>	<b>40°</b>	<b>60°</b>		<b>DALI</b>	
	<b>W40</b> 4000K	<b>1000mm-28W</b>	<b>15x30°</b>	<b>10x60°</b>	<b>ASYM</b>	<b>CAS</b> Casambi	
	<b>W60</b> 6000K	<b>1000mm-42W</b>	<b>ASYM</b>				
			<b>Single Color (SC)</b>				
	<b>R</b> Red	<b>500mm-11W</b>	<b>8°</b>	<b>12,5°</b>	<b>UNIV</b> 100-264Vac	<b>STD</b> ON/OFF	
	<b>B</b> Blue	<b>1000mm-14W</b>	<b>20°</b>	<b>30°</b>	<b>24</b> 24Vdc	<b>010</b> 0-10V	
	<b>G</b> Green	<b>1000mm-22W</b>	<b>40°</b>	<b>60°</b>		<b>DALI</b>	
	<b>A</b> Amber	<b>1000mm-28W</b>	<b>15x30°</b>	<b>10x60°</b>	<b>ASYM</b>	<b>CAS</b> Casambi	
		<b>1000mm-42W</b>	<b>ASYM</b>				
			<b>RGBW</b>				
	<b>RGBW3</b>	<b>1000mm-72W</b>	<b>20°</b>	<b>30°</b>	<b>36</b> 36Vdc	<b>DALI</b>	
4 in 1 Chip		<b>60°</b>	<b>15x60°</b>		<b>DMX</b>		
RGB+W3000K					<b>CAS</b> Casambi		
<b>RGBW4</b>							
4 in 1 Chip							
RGB+W4000K							

Reference example

VL-LN.50-W27-1000mm-42W-10x60-UNIV-STD

## Dimensions

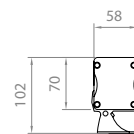
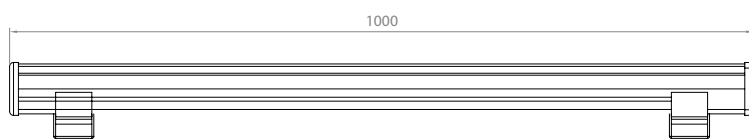

## Accesories

Code	Accesories
<b>VL-LN.50</b>	<b>HC</b> Honeycomb Grid <b>VS</b> Visor

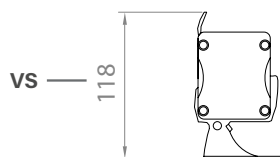
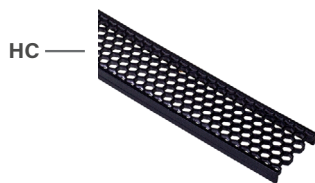

Code	Accesories
<b>VL-LN.50</b>	<b>IO</b> In&out cable with connectors <b>*CBLX</b> Special length cable

*\* Instead of X, put length of cable needed  
Example: VL-LN60-CBL-10m*