

# KUBO.16



IP66	IK09	CREE XP-G	RECYCLE
FAILURE RATE < 0,1% after 25,000h	LIFE TIME Tested over 50,000h	MIN -20°C MAX 55°C	CLASE I
SP US	CE	RoHS	RoHS 2

RECTANGULAR PROJECTORS  
**KUBO SERIES**

## References

Code	Type	Finish	Light Color	Power	Lense		Voltage	Driver	
<b>VL-KUB16</b>	<b>A</b> Base	<b>LG</b> Light grey	<b>White</b>						
	<b>B</b> Base 2	<b>DK</b> Dark grey	<b>W24</b> 2400K	<b>50W</b>	<b>1,5°</b> (50W)	<b>2,5°</b>	<b>UNIV</b> 100-264Vac	<b>STD</b> ON/OFF	
	<b>C</b> Pole Arm	<b>WH</b> White	<b>W27</b> 2700K	<b>75W</b>	<b>4,5°</b>	<b>8°</b>		<b>010</b> 0-10V	
	<b>D</b> Pole mounted	<b>BK</b> Black	<b>W30</b> 3000K		<b>12°</b>	<b>20°</b>		<b>DALI</b>	
	<b>E</b> Stripe mounted	<b>RAL</b> Any RAL color	<b>W40</b> 4000K		<b>30°</b>	<b>40°</b>		<b>CAS</b> Casambi	
			<b>W60</b> 6000K		<b>60°</b>	<b>5x20°</b>			
					<b>10x70°</b>	<b>ASYM</b>			
				<b>Single Color (SC)</b>					
			<b>R</b> Red		<b>75W</b>	<b>2,5°</b>	<b>6°</b>	<b>UNIV</b> 100-264Vac	<b>STD</b> ON/OFF
			<b>B</b> Blue			<b>12°</b>	<b>20°</b>		<b>010</b> 0-10V
			<b>G</b> Green			<b>30°</b>	<b>40°</b>		<b>DALI</b>
			<b>A</b> Amber			<b>60°</b>	<b>5x20°</b>		<b>CAS</b> Casambi
						<b>10x70°</b>			
				<b>RGBW</b>					
			<b>RGBW3</b>		<b>100W</b>	<b>15°</b>	<b>20°</b>	<b>UNIV</b> 100-264Vac	<b>DALI</b>
		4 in 1 Chip			<b>30°</b>	<b>60°</b>	<b>DMX</b>		
		RGB+W3000K			<b>15x60°</b>		<b>36</b> 36Vdc	<b>CAS</b> Casambi	
		<b>RGBW4</b>							
		4 in 1 Chip							
		RGB+W4000K							
		<b>RGBW7</b>							
		7 in 1 Chip							
		RGBWCLA							

Reference example

VL-KUB16-C-DK-W60-75W-20°-UNIV-STD

## Variations



**A**  
Base



**B**  
Base 2



**C**  
Pole Arm  
D=45mm



**D**  
Pole mounted  
D67-325mm

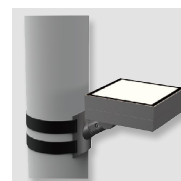

**E**  
Stripe mounted

## Dimensions

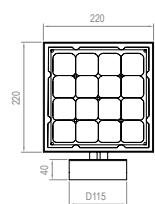

**TYPE A**

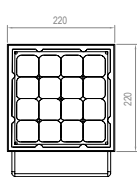
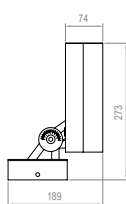

**TYPE B**

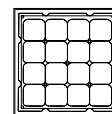
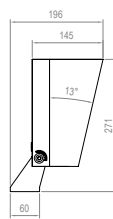

**TYPE C**

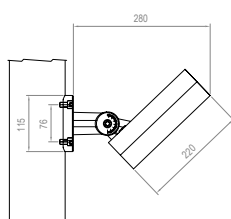
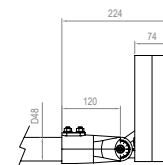

**TYPE D**

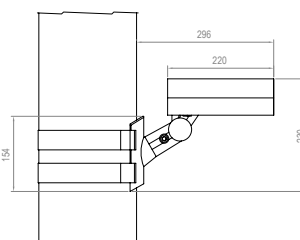

**TYPE E**

## Accessories

Code	Accessories
VL-KUB16	HC Honeycomb Grid MSH Mesh

HC



MSH

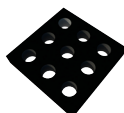

Code	Accessories
VL-KUB16	SHD Shields *1BR Bracket for 1 projector *2BR Bracket for 2 projector *CBLX Special length cable

\* Must be used with Type C  
\* Must be used with Type C  
\* Instead of X, put length of cable needed  
Example: VL-KUB25-CBL-10m

SHD



1BR

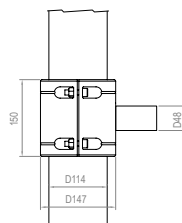

2BR

