

FOX.6



IP66	IK09	CREE XP-G	RECYCLE
FAILURE RATE < 0,1% after 25,000h	LIFE TIME Tested over 50,000h	MIN -20°C MAX 55°C	CLASE I
SP US	RoHS	CE	RoHS 2

CIRCULAR PROJECTORS
FOX SERIES

References

Code	Type	Finish	Light Color	Power	Lense		Voltage	Driver	
VL-F6	A Base	LG Light grey	White						
	B Base 2	DK Dark grey	W24 2400K	22W	1,5° (22W)	2,5°	UNIV 100-264Vac	STD ON/OFF	
	C Pole Arm	WH White	W27 2700K	30W	6°	12°		24 24Vdc	010 0-10V
	D Pole mounted	BK Black	W30 3000K		20°	30°	24 24Vdc		DALI
	E Stripe mounted	RAL Any RAL color	W40 4000K		40°	60°		24 24Vdc	DALI
	F Nut		W60 6000K		5x20°	10x70°	CAS Casambi		
				Single Color (SC)					
				R Red	22W	2,5°	6°	UNIV 100-264Vac	STD ON/OFF
				B Blue	30W	12°	20°		24 24Vdc
				G Green		30°	40°	24 24Vdc	
				A Amber		60°	5x20°		24 24Vdc
						10x70°	10x70°	CAS Casambi	
				RGBW					
				RGBW3	30W	8°	15°	UNIV 100-264Vac	DALI
				4 in 1 Chip	36W	20°	30°		24 24Vdc
			RGB+W3000K		60°	15x60°	24 24Vdc	CAS Casambi	
			RGBW4						
			4 in 1 Chip						
			RGB+W4000K						

Reference example

VL-F6-A-DK-RGBW3-36W-15°-24-DMX

Variations



A
Base



B
Base 2



C
Pole Arm
D=45mm



D
Pole mounted
D67-325mm



E
Stripe mounted



F
Nut (M10x1,5mm)

Dimensions

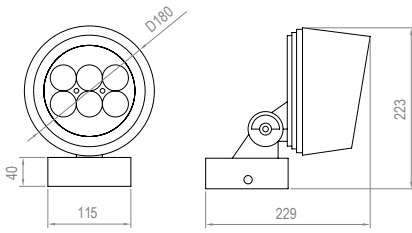

TYPE A

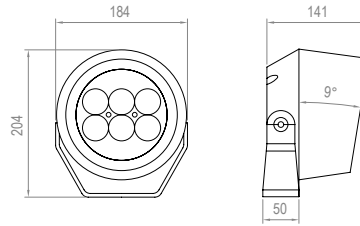

TYPE B

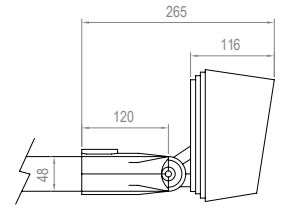

TYPE C

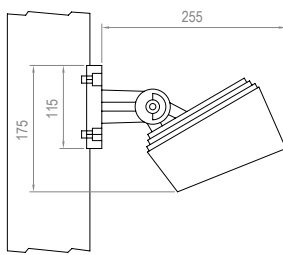

TYPE D

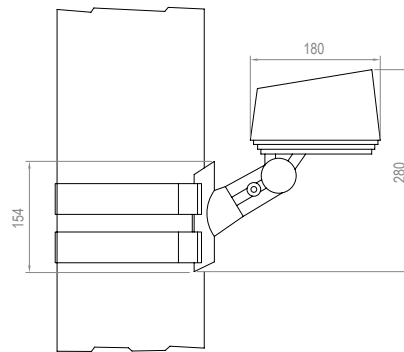

TYPE E

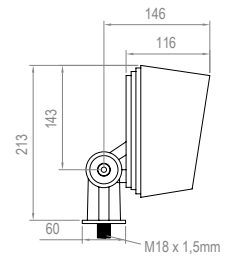

TYPE F

Accessories

Code	Accessories
------	-------------

VL-F6 HC Honeycomb Grid
MSH Mesh

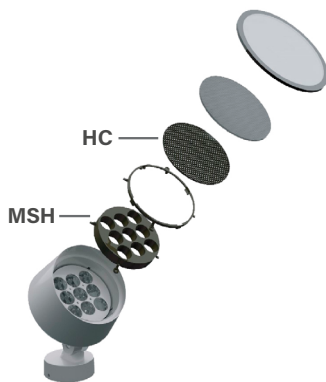

Code	Accessories
------	-------------

VL-F6 *SPK SPIKE
*1BR Bracket for 1 projector
*2BR Bracket for 2 projector
*BX Elevated Box
*CBLX Special length cable
** Must be used with Type F*
** Must be used with Type C*
** Must be used with Type F*
** Instead of X, put length of cable needed*
Example: VL-F6-CBL-10m



SPK

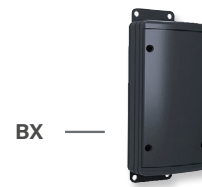
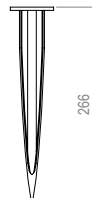

BX

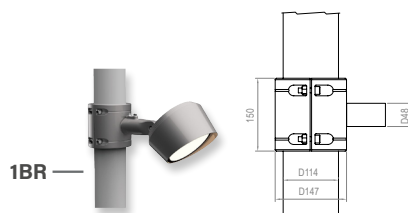
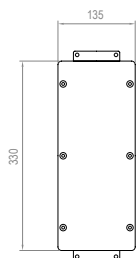

1BR

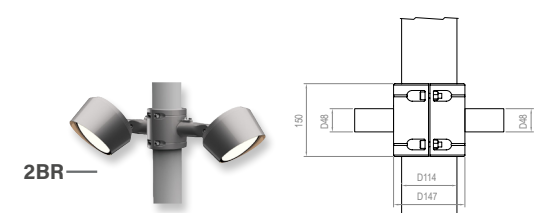

2BR