

FOX.16



IP66	IK09	CREE XP-G	RECYCLE
FAILURE RATE < 0,1% after 25,000h	LIFE TIME Tested over 50,000h	MIN -20°C MAX 55°C	CLASE I
SP US	CE	RoHS	RoHS 2

CIRCULAR PROJECTORS
FOX SERIES

References

Code	Type	Finish	Light Color	Power	Lense		Voltage	Driver	
VL-F16	A Base	LG Light grey	White						
	B Base 2	DK Dark grey	W24 2400K	40W	1,5° (40W)	2,5°	UNIV 100-264Vac	STD ON/OFF	
	C Pole Arm	WH White	W27 2700K	60W	6°	12°		010 0-10V	
	D Pole mounted	BK Black	W30 3000K	75W	20°	30°	24 24Vdc	DALI	
	E Stripe mounted	RAL Any RAL color	W40 4000K		40°	60°		CAS Casambi	
				W60 6000K		5x20°	10x70°		
				Single Color (SC)					
				R Red	60W	2,5°	6°	UNIV 100-264Vac	STD ON/OFF
				B Blue	75W	12°	20°		010 0-10V
				G Green		30°	40°	24 24Vdc	DALI
				A Amber		60°	5x20°		CAS Casambi
				RGBW					
				RGBW3	100W	15°	20°	UNIV 100-264Vac	DALI
				4 in 1 Chip RGB+W3000K		30°	60°		36 36Vdc
				RGBW4		15x60°			CAS Casambi
			4 in 1 Chip RGB+W4000K						
			RGBW7						
			7 in 1 Chip RGBWCLA						

Reference example

VL-F16-C-DK-W60-75W-20°-UNIV-STD

Variations



A
Base



B
Base 2



C
Pole Arm
D=45mm



D
Pole mounted
D67-325mm



E
Stripe mounted

Dimensions

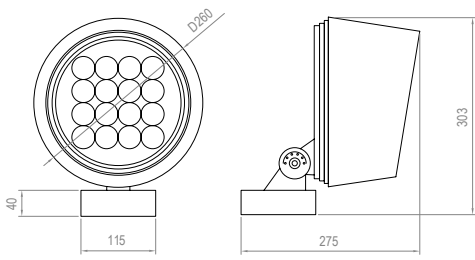

TYPE A

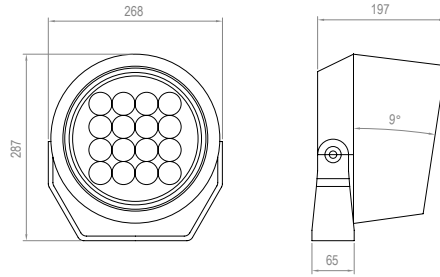

TYPE B

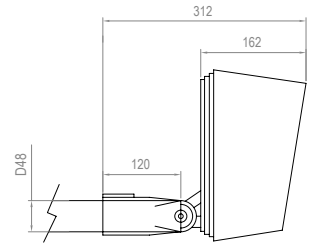

TYPE C

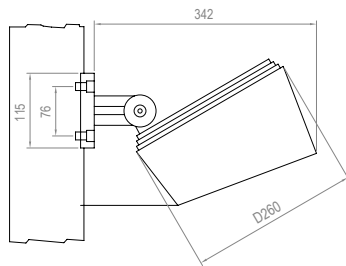

TYPE D

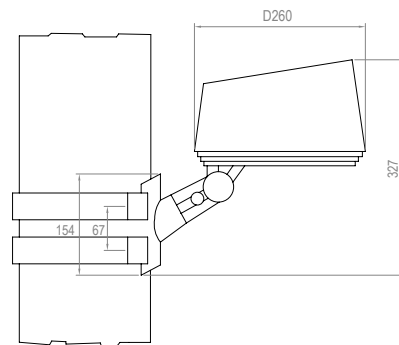

TYPE E

Accessories

Code	Accessories
VL-F16	<p>HC Honeycomb Grid</p> <p>MSH Mesh</p>

Code	Accessories
VL-F16	<p>*1BR Bracket for 1 projector</p> <p>*2BR Bracket for 2 projector</p> <p>*CBLX Special length cable</p> <p><i>* Must be used with Type C</i></p> <p><i>* Must be used with Type C</i></p> <p><i>* Instead of X, put length of cable needed</i></p> <p><i>Example: VL-F16-CBL-10m</i></p>



1BR

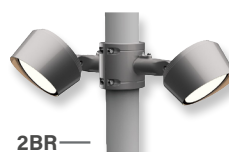
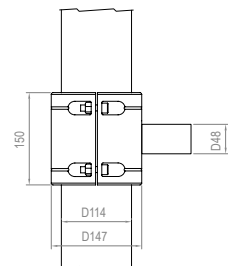

2BR

